

Assembly Instruction

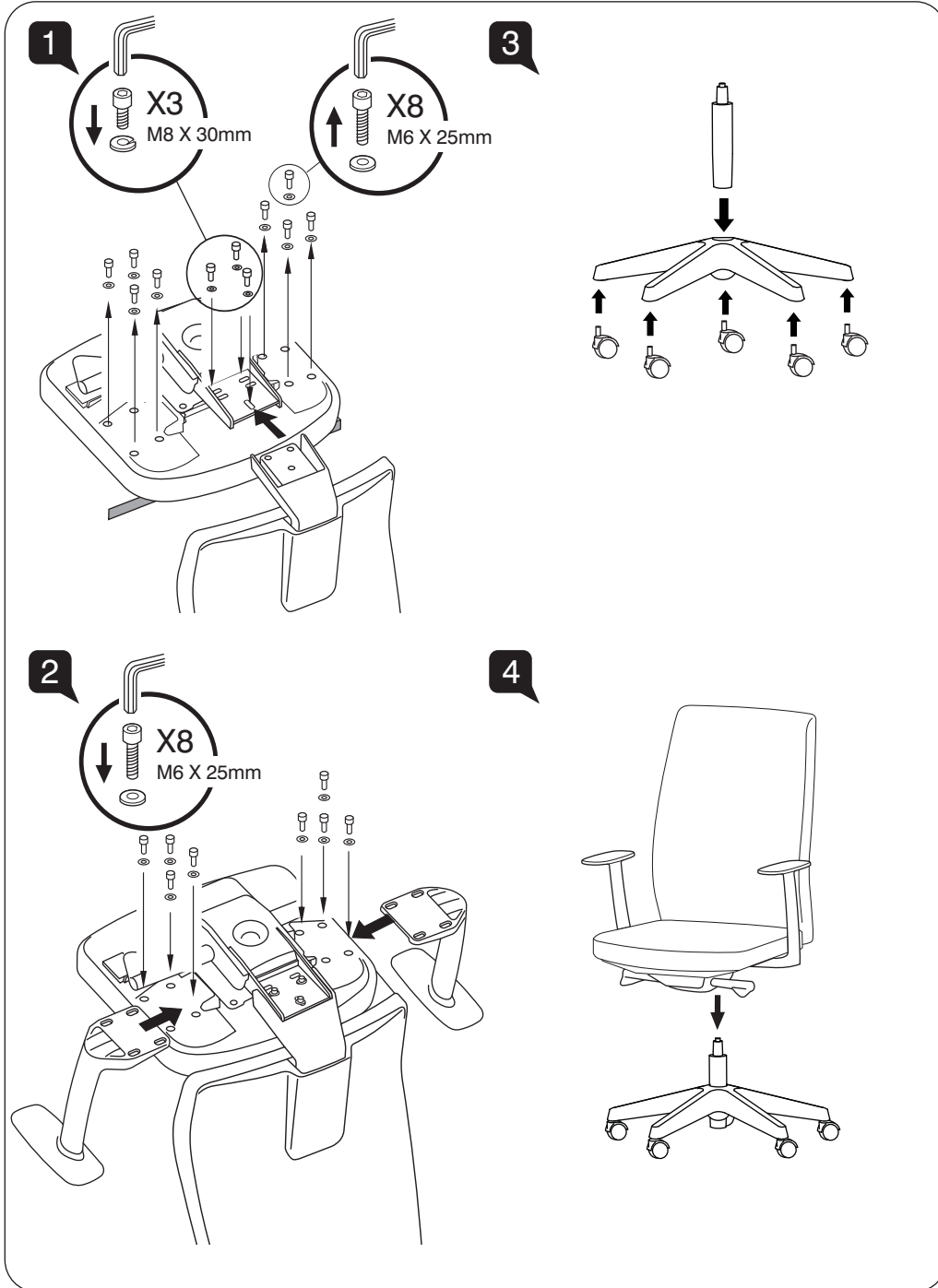

User Instructions

WORK

Model

1268 YM A82 M2

- A** **Seat Height Adjustable**
Flip up lever on right-side to raise or lower seat. Adjust such that your feet are adequately supported on floor.
- B** **Tilt Lock**
There are 3 locking positions for this model. At upright position or recline to the desired angle and push in lever to lock. Pull out lever to release tilt-lock.
- C** **Backrest Height**
Hold backrest by both sides and pull up, one step at a time, to desired height. To lower backrest, pull it up till maximum height and then, return it to lowest height to start again. Adjust height so that the backrest curvature follows the curve of your back.

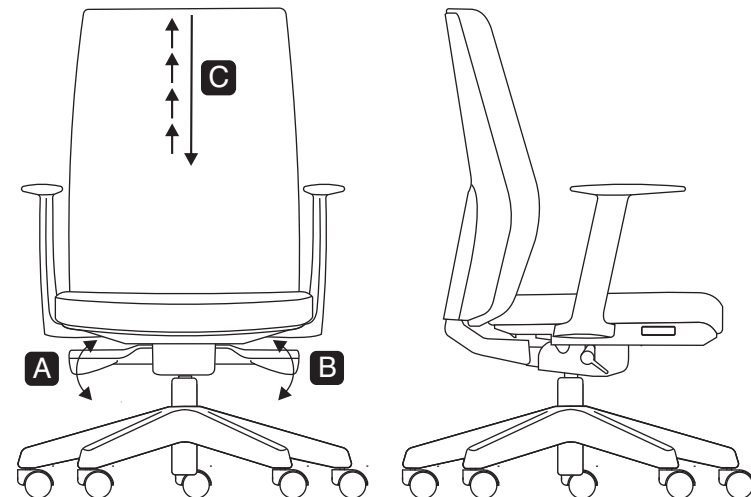

MERRYFAIR®