

Assembly Instruction

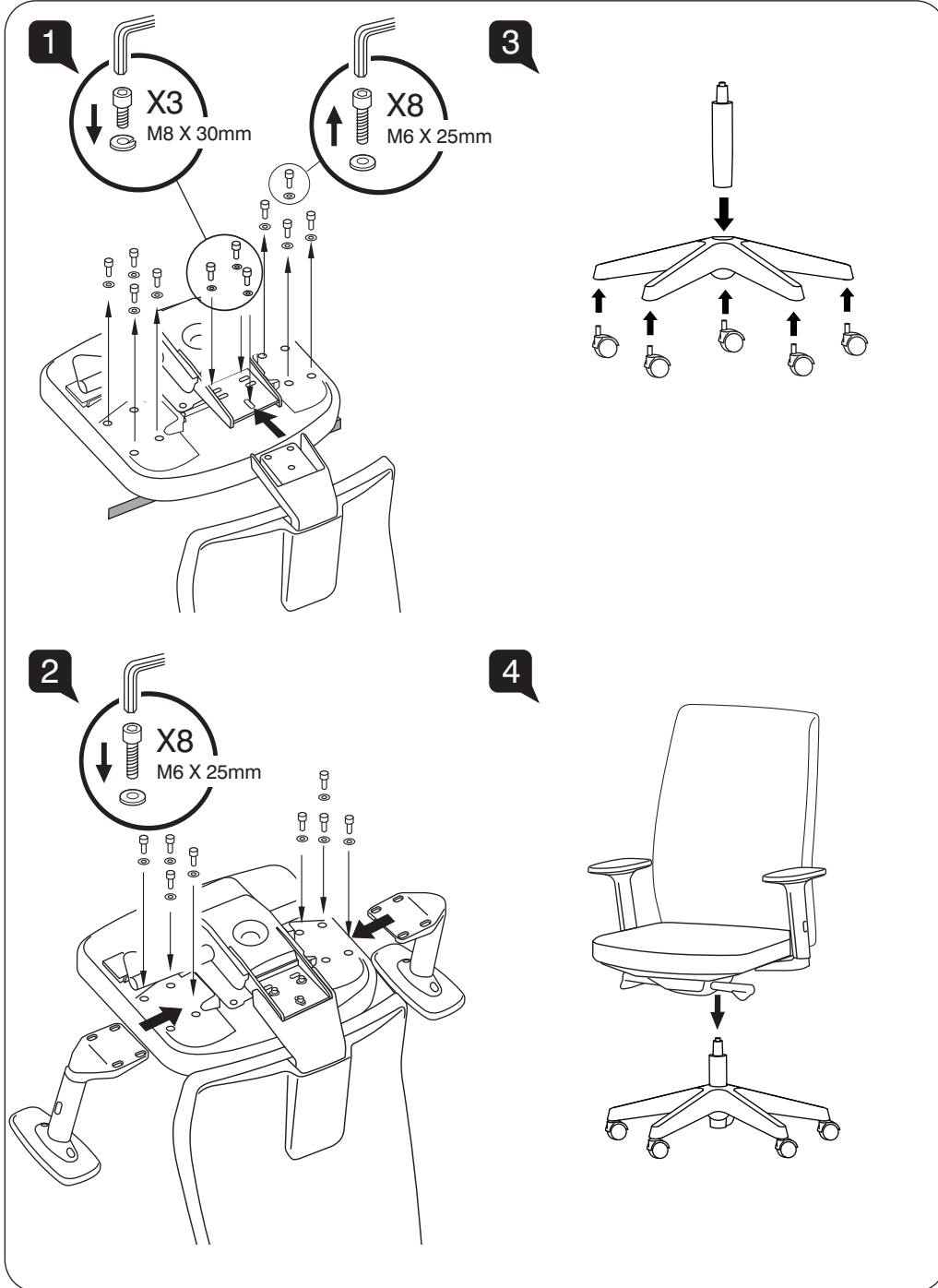

WORK

Model

1268 YM A78 M2

User Instructions

- A Seat Height Adjustable**
Flip up lever on right-side to raise or lower seat. Adjust such that your feet are adequately supported on floor.
- B Tilt Lock**
There are 3 locking positions for this model. At upright position or recline to the desired angle and push in lever to lock. Pull out lever to release tilt-lock.
- C Backrest Height**
Hold backrest by both sides and pull up, one step at a time, to desired height. To lower backrest, pull it up till maximum height and then, return it to lowest height to start again. Adjust height so that the backrest curvature follows the curve of your back.
- D Armrest Height**
Press the button and raise or lower the armrest. Adjust height to adequately support elbows to take strain off shoulders
- E Armpad Angle**
Grasp armpads and rotate them inwards or outwards to adjust elbow support to suite specific tasks. An inward position works during keyboard use, while an outward position is recommended during mousing.
- F Armrest Depth**
Grasp armpads and push them forwards and backwards to suite your arm support.

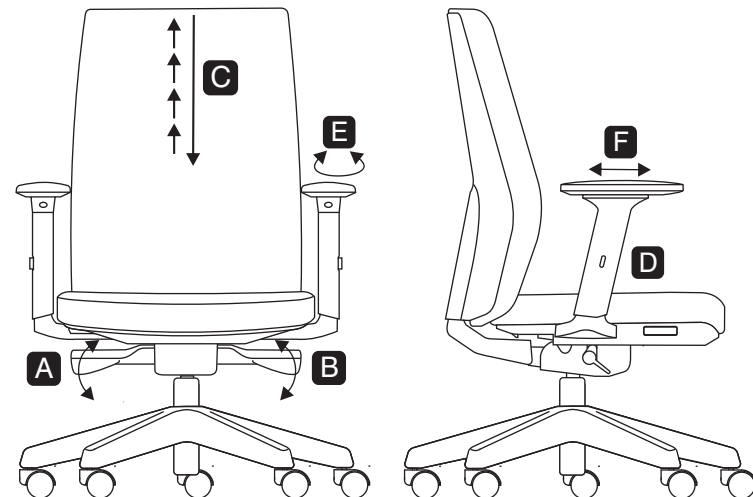

MERRYFAIR®