

Assembly Instruction

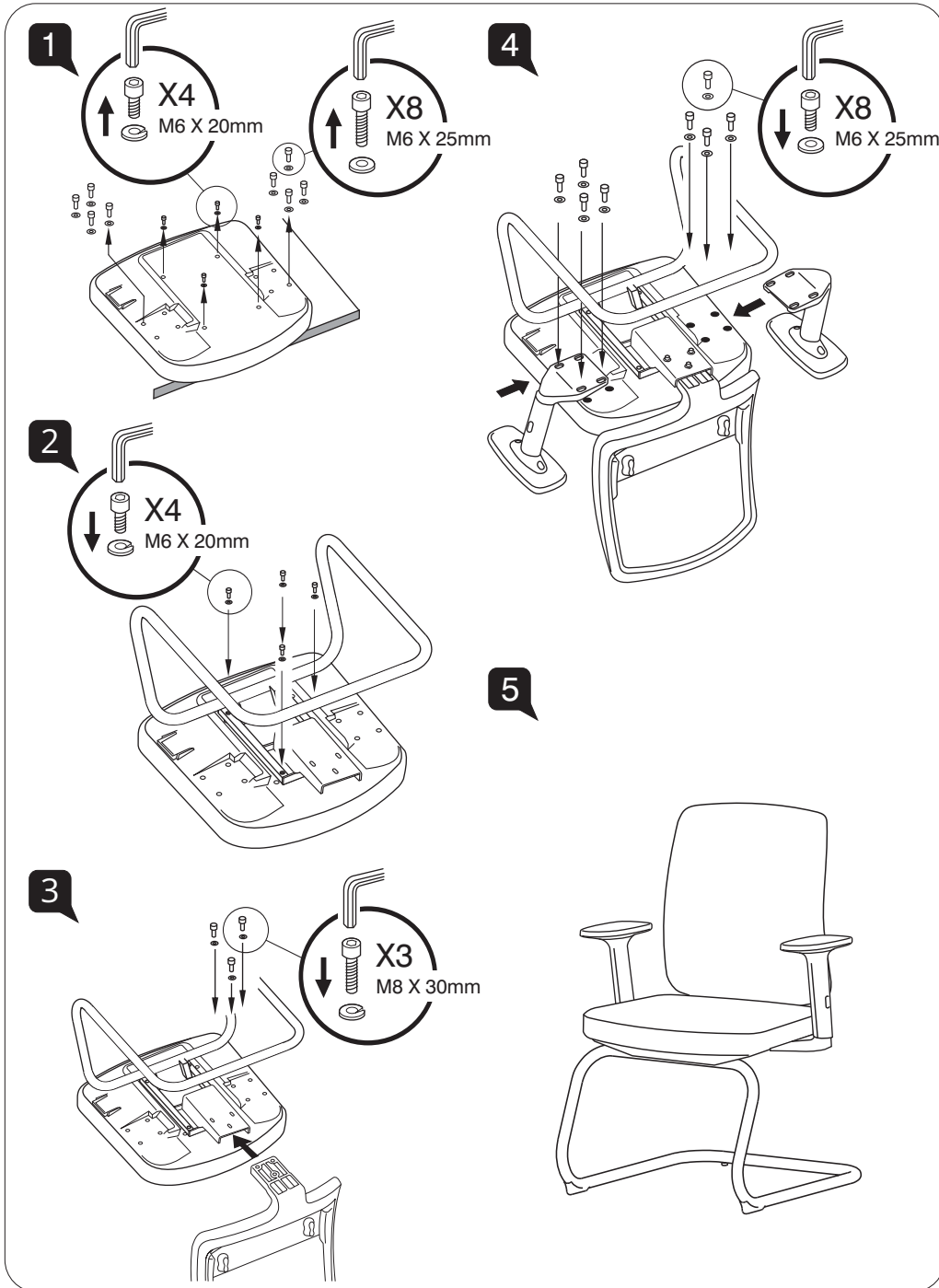

WORK

Models

1241 NA A78 B

1251 NA A78 B

User Instructions

- A Lumbar Height Adjustment** (For 1251 Model)
Slide the lumbar support up or down for desired lumbar position.
- B Armrest Height**
Press the button and raise or lower the armrest. Adjust height to adequately support elbows to take strain off shoulders
- C Armpad Angle**
Grasp armpads and rotate them inwards or outwards to adjust elbow support to suite specific tasks. An inward position works during keyboard use, while an outward position is recommended during mousing.
- D Armrest Depth**
Grasp armpads and push them forwards and backwards to suite your arm support.

